

Fanless Embedded System



Specifications



External I/O



Adapter

Powder Cord



WI-FI Antenna

Din Rail Clip

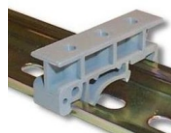

WALL Mount + VESA

DVD Driver



Packing List

Parts Number	Description	Set
-----	JBC313U591(W)-3160-B	1
G03-JC31301G01-F	313 Series Quick Installation Guide	1
G02-DVD20-AI2-WF	Intel Braswell DVD Driver	1
HLMAP-FSP040-F	Adapter 12V/40W/3.3A FSP040-RHAN2	1
-----	Power cord (Depends on area / country)	1
HCS310MWM01B-1F	JC310/410 Wall+VESA mount bracket	1
LCSCHBJC3XX-F	Screw Pack	1
HCS3XXDINRAILPS-F	Din Rail Clip	1

Fanless Embedded System: Specifications

Specification	
Dimension	116 (W) x 110 (D) x 49 (H) mm
Construction	Top cover & I/O plate – Aluminium; Base- Metal
Colors	HBJC313U591(W)-3160-B
MB model	JNU591-3160
CPU	Intel® Braswell N3160 SoC Processor 1.6GHz (up to 2.24GHz)
BIOS	AMI UEFI 64 Mb
Memory	1 x DDR3L SO-DIMM slot (Max. to 8GB)
Front I/O Port	2 x USB 3.0 (type A) 1 x COM 1 x Power Knob
Rear I/O Port	2 x USB 3.0 (type A) 2 x HDMI (1.4b) 1 x DP (1.1a) 2 x RJ45 (Giga LAN) Wi-Fi (option) 1 x Line out / MIC Combo 1 x DC-in jack
Expansion Slot	1 x half size Mini PCIe slot 1 x full size Mini PCIe slot Mini PCIe/ mSATA Device 1 x SIM card holder
Power Source	Adapter : A_90~240V / DC_12V / 40W
Certification	EMC : CE, FCC Safety : RoHS, ErP
Environment	Operating Temperature : 0°C – 50°C with air flow (mSATA) Storage Temperature : -10°C – 70°C Vibration During Operation : N/A Shock During Operation : N/A
Mounting Bracket	Wall / VESA / DIN Rail Multi purpose mounting Kit
Packing	Net Weight : 0.9Kg Gross Weight : 1.3Kg Color Box Dimension : 158 (W) x 167 (D) x 123.6(H) mm
Warranty	2 Year limited warranty